

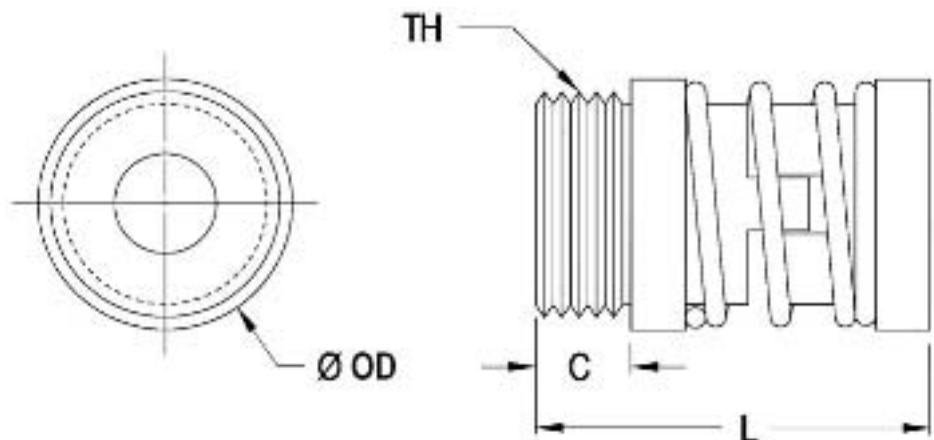

Anti-Backlash SUPERNUTS™



ANTI-BACKLASH SUPERNUTS™

MATERIAL: Acetal with PTFE

TEMPERATURE RANGE: Min. 32°F, Max. 180°F

INCH

All dimensions are expressed in inches, unless otherwise noted.

Catalog Number	Screw Size O.D. - # Thds. - Starts	Lead	OD	L		C	TH	Pre Load (lbs)	Design Load	Max Static Load	Efficiency %	Drag Torque (oz-in)	Flange HB250F-
				Min.	Max.								
HB22SN-25161AB	1/4 - 16 - 1st	.063	.625	1.125	1.25	.187	9/16 - 18	1 - 3	25 lbs	225 lbs	48	41	025
HB22SN-25201AB	1/4 - 20 - 1st	.050											
HB22SN-31082AB	5/16 - 8 - 2st	.250	.750	1.160	1.34	.250	5/8 - 18	2 - 5	50 lbs	350 lbs	72	80	037
HB22SN-31084AB	5/16 - 8 - 4st	.500											
HB22SN-31122AB	5/16 - 12 - 2st	.167	.750	1.160	1.34	.250	5/8 - 18	2 - 5	70 lbs	350 lbs	65	65	037
HB22SN-37081AB	3/8 - 8 - stub	.125											
HB22SN-37084AB	3/8 - 8 - 4st	.500											
HB22SN-37101AB	3/8 - 10 - 1st	.100											
HB22SN-37102AB	3/8 - 10 - 2st	.200											
HB22SN-37114AB	3/8 - 11 - 4st	.375											
HB22SN-37121AB	3/8 - 12 - 1st	.083											
HB22SN-37122AB	3/8 - 12 - 2st	.167											
HB22SN-37161AB	3/8 - 16 - 1st	.063											
HB22SN-43082AB	7/16 - 8 - 2st	.250											
HB22SN-43084AB	7/16 - 8 - 4st	.500											
HB22SN-50042AB	1/2 - 4 - 2st	.500	1.000	1.700	2.00	.375	15/16 - 16	4 - 9	150 lbs	750 lbs	75	41	5 - 8
HB22SN-50101AB	1/2 - 10 - 1st	.100											
HB22SN-50102AB	1/2 - 10 - 2st	.200											
HB22SN-62081AB	5/8 - 8 - stub	.125	1.000	1.700	2.00	.375	15/16 - 16	4 - 9	160 lbs	800 lbs	40	35	7 - 10
HB22SN-62101AB	5/8 - 10 - 1st	.100											
HB22SN-62102AB	5/8 - 10 - 2st	.200											
HB22SN-75061AB	3/4 - 6 - 1st	.167	1.750	2.500	3.00	.375	1-9/16-18	10 - 20	300 lbs	1500 lbs	44	36	15 - 20
HB22SN-75081AB	3/4 - 8 - 1st	.125											
HB22SN-75101AB	3/4 - 10 - 1st	.100											
HB22SN-10005AB	1 - 5 - 1st	.200	1.750	2.500	3.00	.600	1-9/16-18	10 - 20	400 lbs	2000 lbs	41	29	15 - 20
HB22SN-10008AB	1 - 8 - 1st	.125											
HB22SN-10010AB	1 - 10 - 1st	.100											

METRIC

Catalog Number	Screw Size O.D. (mm) - # Thds. (mm) - Starts	Lead (mm)	OD	L		C	TH	Pre Load (lbs)	Design Load	Max Static Load	Efficiency %	Drag Torque (oz-in)	Flange HB250F-
				Min.	Max.								
HB22SNM10021AB	10 - 0.5 - 1	2	.75	1.16	1.34	.250	5/8-18	2 - 5	70 lbs	350 lbs	41	2 - 4	037
HB22SNM10031AB	10 - 0.333 - 1	3	.75	1.16	1.34	.250	5/8-18	2 - 5	70 lbs	350 lbs	53	2 - 4	037
HB22SNM10206AB	10 - 0.3 - 6	20	.75	1.16	1.34	.250	5/8-18	2 - 5	70 lbs	350 lbs	81	2 - 4	037
HB22SNM12052AB	12 - 0.4 - 2	5	1.00	1.70	2.00	.375	15/16-16	4 - 9	100 lbs	500 lbs	59	3 - 5	050
HB22SNM16041AB	16 - 0.25 - 1	4	1.00	1.70	2.00	.375	15/16-16	4 - 9	160 lbs	800 lbs	47	7 - 10	050
HB22SNM20041AB	20 - 0.25 - 1	4	1.75	2.50	3.00	.600	1 9/16-18	10 - 20	300 lbs	1500 lbs	41	15 - 20	100
HB22SNM24051AB	24 - 0.2 - 1	5	1.75	2.50	3.00	.600	1 9/16-18	10 - 20	300 lbs	1500 lbs	42	15 - 20	100

4 Acme Screws & Nuts