

Carbide-Tipped Double-Edge Round & Route

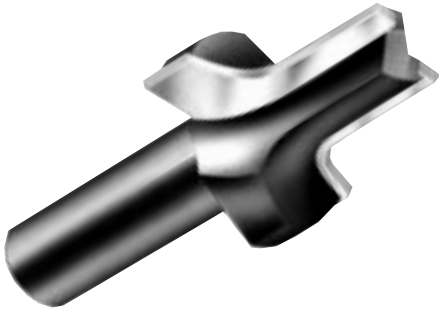

These two-flute cutters were designed to put a radius on the edge and dress the stock. They will provide a smooth finish on natural woods and wood composites.

Primary usage:

Natural wood, plywood and wood composites

Secondary usage:

Nonabrasive plastics

Catalog Number	CED	Small CED	CEL	Shank Dia.	OAL	CE Radius	Price
H25D67-064190841	1"	1/2"	1-3/16"	1/2"	2-9/16"	3/16"	\$121.05
H25D67-064270849	1"	1/2"	1-11/16"	1/2"	3-1/16"	3/16"	\$127.80
H25D67-072190841	1-1/8"	1/2"	1-3/16"	1/2"	2-9/16"	1/4"	\$141.35
H25D67-072270849	1-1/8"	1/2"	1-11/16"	1/2"	3-1/16"	1/4"	\$155.00
H25D67-088190841	1-3/8"	1/2"	1-3/16"	1/2"	2-9/16"	3/8"	\$168.50
H25D67-088270849	1-3/8"	1/2"	1-11/16"	1/2"	3-1/16"	3/8"	\$187.80

NOTES

CED Cutting Edge Diameter

CEL Cutting Edge Length

OAL Overall Length

Carbide-Tipped Double-Edge Round Nose



Produce beautiful decorative effects. Give panels, doors, drawers or almost any surface a special touch with a delicate cove or an eye-catching vein.

Primary usage:

Natural woods and wood composites

Secondary usage:

Plastic and other composite materials

Catalog Number	CED	CEL	Shank Dia.	OAL	CE Radius	Price
H25N68-008060424*	1/8"	3/8"	1/4"	1-1/2"	1/16"	\$22.50
H25N68-016040424*	1/4"	1/4"	1/4"	1-1/2"	1/8"	\$18.10
H25D68-024040430	3/8"	1/4"	1/4"	1-7/8"	3/16"	\$24.70
H25D68-032060431	1/2"	3/8"	1/4"	1-15/16"	1/4"	\$27.10
H25D68-040060434	5/8"	3/8"	1/4"	2-1/8"	5/16"	\$27.10
H25D68-048070433	3/4"	7/16"	1/4"	2-1/16"	3/8"	\$32.40
H25N68-016100836*	1/4"	5/8"	1/2"	2-1/4"	1/8"	\$24.70
H25D68-032200846	1/2"	1-1/4"	1/2"	2-7/8"	1/4"	\$35.50
H25D68-048200846	3/4"	1-1/4"	1/2"	2-7/8"	3/8"	\$40.50
H25D68-064200848	1"	1-1/4"	1/2"	3"	1/2"	\$51.20

NOTES

CED Cutting Edge Diameter

CEL Cutting Edge Length

OAL Overall Length

* Solid Carbide Bit