

**FEATURES:**

- Two Standard-Duty Slides (page 72) can be mounted together to provide XY positioning tables
- Two Configurations:
  1. Bearing plate of bottom slide to the bearing plate of the top slide
  - or
  2. Bearing plate of bottom slide to base of the top slide
- The plates are supplied with all mounting hardware

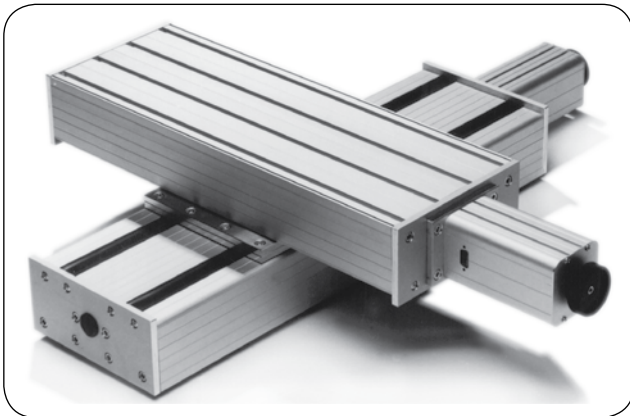
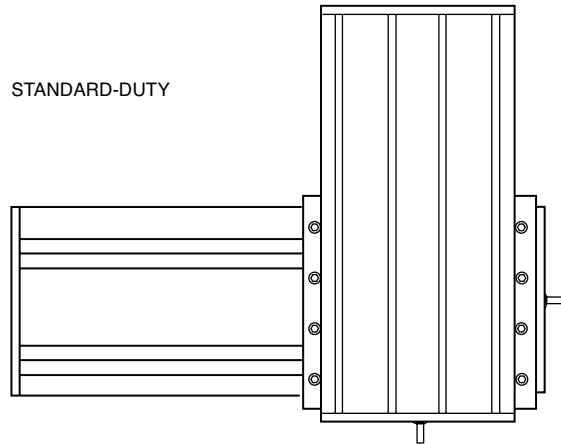
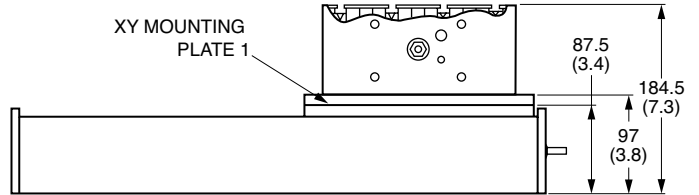

Bearing plate to bearing plate mounting shown

See Web site for complete CAD drawings

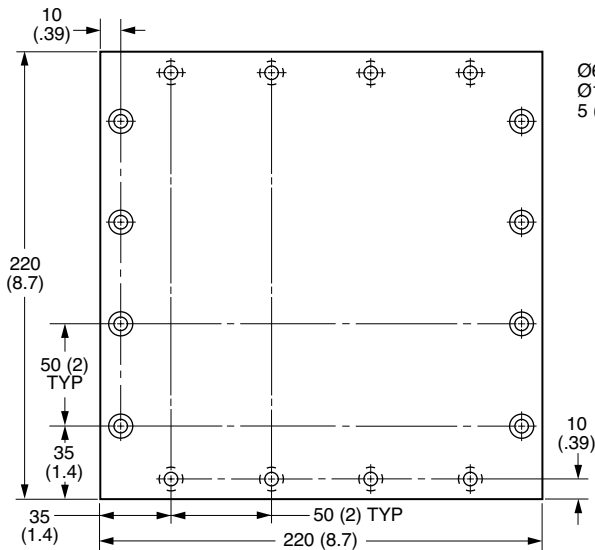

Ø6.35 (.250)  
Ø12 (.47) C'BORE  
5 (.20) DP (16 PLACES)

XY Adapter Plate for Standard-Duty Slides.  
Provided with 16 pieces of M6 x 12 socket head cap screws and eight M6 square nuts.

Catalog Number	Description
HS4700MXY-1	XY Mounting Plate 1

**NOTE:** Dimensions in ( ) are inch

**FEATURES:**

- Two heavy-duty slide 2's can be mounted together to provide XY positioning tables
- One Configuration:
  1. Bearing plate of bottom slide to the bearing plate of the top slide
- The set consists of two pieces, and is made of flat milled steel, 8 mm thick
- The plates are supplied with all mounting hardware

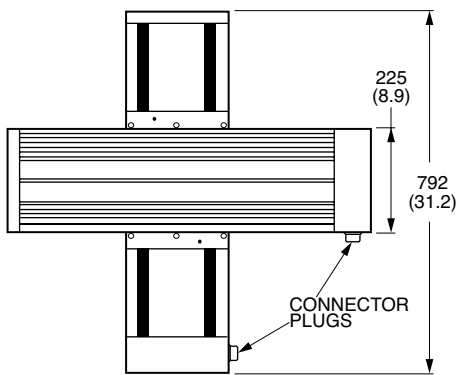
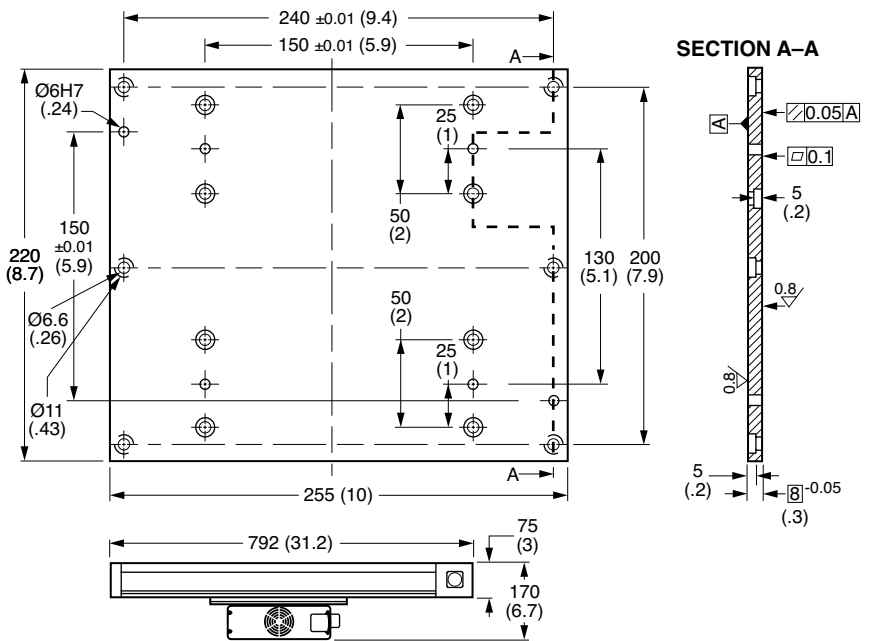
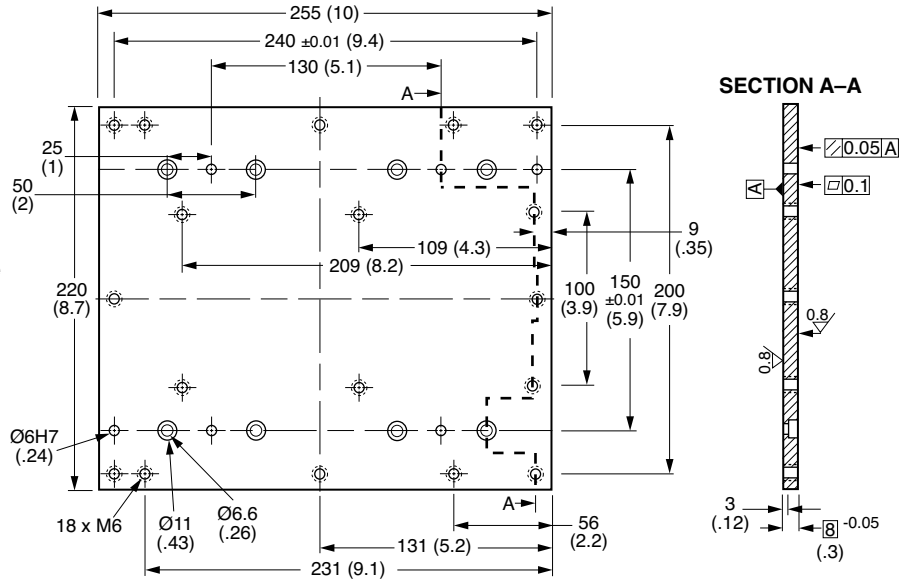

See Web site for complete CAD drawings

**NOTE:** Dimensions in ( ) are inch

Catalog Number	Part Description
HS4700MX-3	XY Mounting Plate 3

